

30" Enclosed Worktable with Cabinet, Sliding Doors, and Backsplash

- Constructed in 18 Gauge & 430 Stainless Steel
- Enclosed cabinet with sliding doors recessed handle
- Stainless Steel Bullet Feet
- 4" x 1" Backsplash



Enhance productivity with Zanduco's modular worktables featuring cabinets with seamless edges. Perfectly suited for bustling commercial kitchens, these tables facilitate food preparation in high-demand environments. Crafted from premium 430 and 304 stainless steel, they boast enclosed cabinets equipped with sliding doors and recessed handles, offering convenient storage for kitchen equipment and essential supplies.

Item	Description (DxWxH)	Mid-Shelf Capacity	Top Capacity	Undershelf Capacity	Height	Packaging Weight	Gross Dimensions
16000-401	30" x 48" (with 4" Backsplash)	260 lbs. 117.9 kg.	690 lbs. 313 kg.	420 lbs. 90.5 kg.	38"	122 lbs. 55.33 kg.	49" x 31" x 11"
16000-402	30" x 60" (with 4" Backsplash)	270 lbs. 122.5 kg.	750 lbs. 340.2 kg.	440 lbs. 199.6 kg.	38"	140 lbs. 63.5 kg.	62" x 32" x 11"
16000-403	30" x 72" (with 4" Backsplash)	280 lbs. 127 kg.	810 lbs. 367.4 kg.	460 lbs. 208.7 kg.	38"	163 lbs. 74 kg.	74" x 33" x 11"



180 DAYS
LIMITED WARRANTY

Email: sales@zanduco.com
Call: 1-855-ZANDUCO
(1-855-926-3826)

www.zanduco.com

30" Enclosed Worktable with Cabinet, Sliding Doors, and Backsplash

Technical Drawings & Dimensions SKU# 16000-401

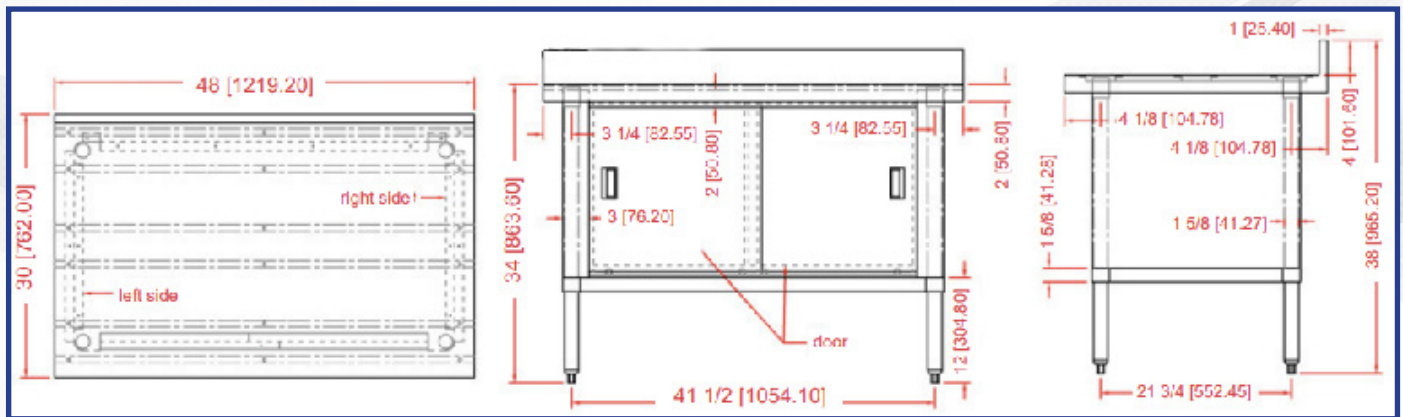

Technical Drawings & Dimensions SKU# 16000-402

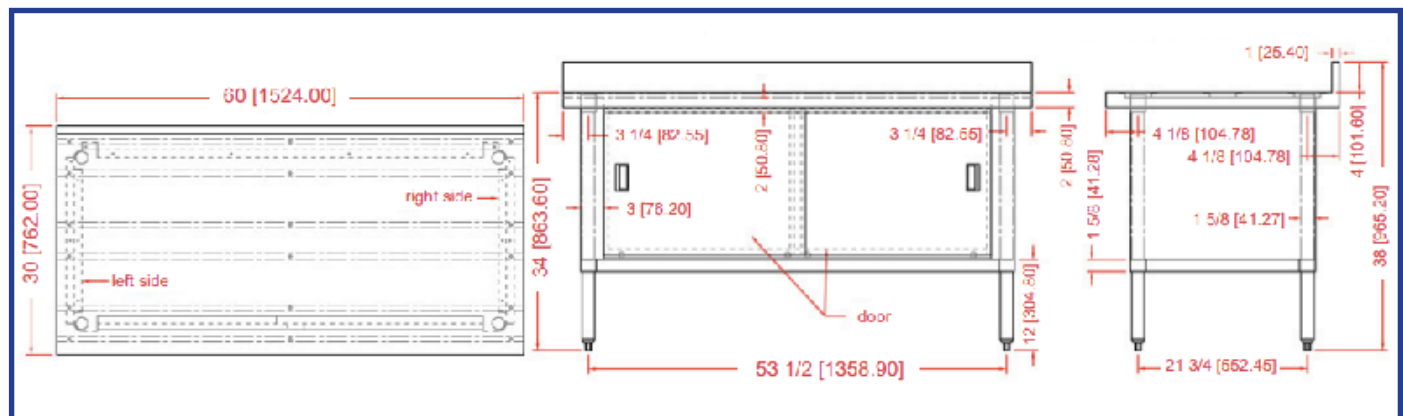

180 DAYS
LIMITED WARRANTY

Email: sales@zanduco.com
Call: 1-855-ZANDUCO
(1-855-926-3826)

www.zanduco.com

30" Enclosed Worktable with Cabinet, Sliding Doors, and Backsplash

Technical Drawings & Dimensions SKU# 16000-403

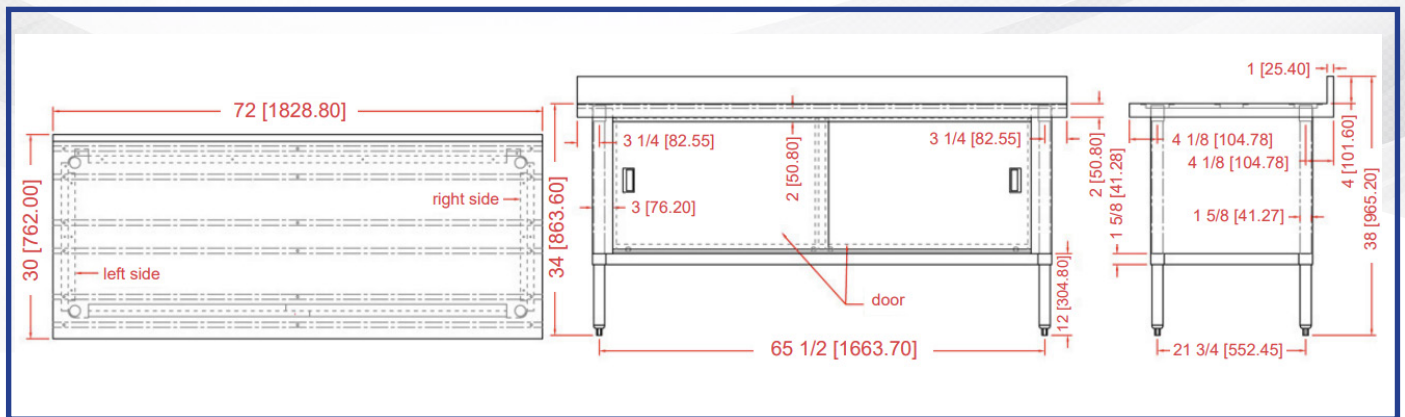

180 DAYS
LIMITED WARRANTY

Email: sales@zanduco.com
Call: 1-855-ZANDUCO
(1-855-926-3826)

www.zanduco.com