

49" GLASS SWING DOOR BACK BAR COOLER

Perfect for any restaurant and/or bar, this heavy duty glass door bottle cooler is designed with enduring quality and value. The exterior comprises of heavy-duty wear resistant black coating paint. Black resistant coating exterior and stainless steel interior. Equipped with positive seal doors, lock, key and LED lights.

Features:

- Interior - stainless steel floor and side
- Exterior - heavy duty, wear black resistant coating paint
- Positive seal doors with lock and key
- LED light
- Product capacity: 672 - 12 oz. cans / 2 kegs / 384 - 12 oz. bottles



ITEM #	12000-790
POWER	1/5 HP
CAPACITY	11.8 cu. ft. / 335 L
PRODUCT CAPACITY	(672) 12 oz. cans, (2) kegs, (384) 12 oz. bottles
TEMPERATURE RANGE	33 ~ 41°F / 0 ~ 5°C
REFRIGERANT	R290
ELECTRICAL	115V/60Hz/1Ph
NET WEIGHT	216 lbs. / 98 kg.
GROSS WEIGHT	260 lbs. / 118 kg.
INTERIOR DIMENSIONS	36.25" x 18.5" x 30.5" / 920 x 470 x 775 mm
NET DIMENSIONS	48.8" x 24.4" x 35.6" / 1240 x 620 x 905 mm
GROSS DIMENSIONS	51.1" x 27.5" x 42.4" / 1300 x 700 x 1075 mm

TECHNICAL DRAWING WITH DIMENSIONS

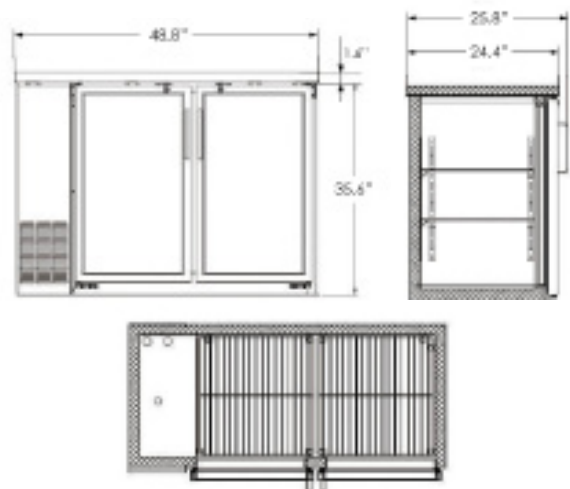

2 YEAR
WARRANTY
PARTS AND LABOUR
5 YEARS ONLY ON COMPRESSOR



Item shipped on pallet
NEMA 5-15

Sales@zanduco.com
Call: 1-855-ZANDUCO
(1-855-926-3826)

www.zanduco.com