

# Refrigerated Topping Rail with Sneeze Guard

SKU: 16000-713      16000-714      16000-740



16000-713



16000-714



16000-740

\*Pans not included

## Elevate your food prep station with these fantastic refrigerated topping rails!

Perfect for keeping a variety of foods and ingredient fresh and properly cooled, this unit is built to impress. Crafted from durable AISI 304 stainless steel, it guarantees long-lasting performance and easy cleaning. The digital LED temperature display provides precise control and unmatched convenience, making it a must have for any busy kitchen.

Ideal for buffet establishments aiming to maintain top-quality, fresh products while minimizing food waste. Plus, it easily accommodates various combinations of plastic or stainless steel table pans for ultimate versatility!

MADE IN CHINA

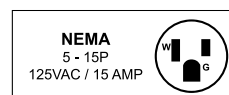

**1 YEAR**  
WARRANTY  
PARTS & LABOUR

TECHNICAL SPECIFICATION			
SKU	16000-713	16000-714	16000-740
Pan Capacity	4 x GN 1/3	6 x GN 1/3	9 x GN 1/3
Electrical	1.6A	1.8A	2A
Power	140W		
Refrigerant	R600a		
Temperature Range	36°F - 50°F		
Plug Type	5-15P		
Net Dimensions	47" x 15.5" x 17" 1200 x 395 x 435 mm	59" x 15.5" x 17" 1500 x 395 x 435 mm	78.7" x 15.5" x 17" 2000 x 395 x 435 mm
Net Weight	88 lbs.   40 kg.	132 lbs.   60 kg.	176 lbs.   80 kg.
Gross Dimensions	48.8" x 17" x 18" 1240 x 435 x 460 mm	60.6" x 14.7" x 18" 1540 x 375 x 460 mm	80" x 17" x 18" 2040 x 435 x 460 mm
Gross Weight	176 lbs.   80 kg.	234 lbs.   106 kg.	282 lbs.   128 kg.

## TECHNICAL DRAWING

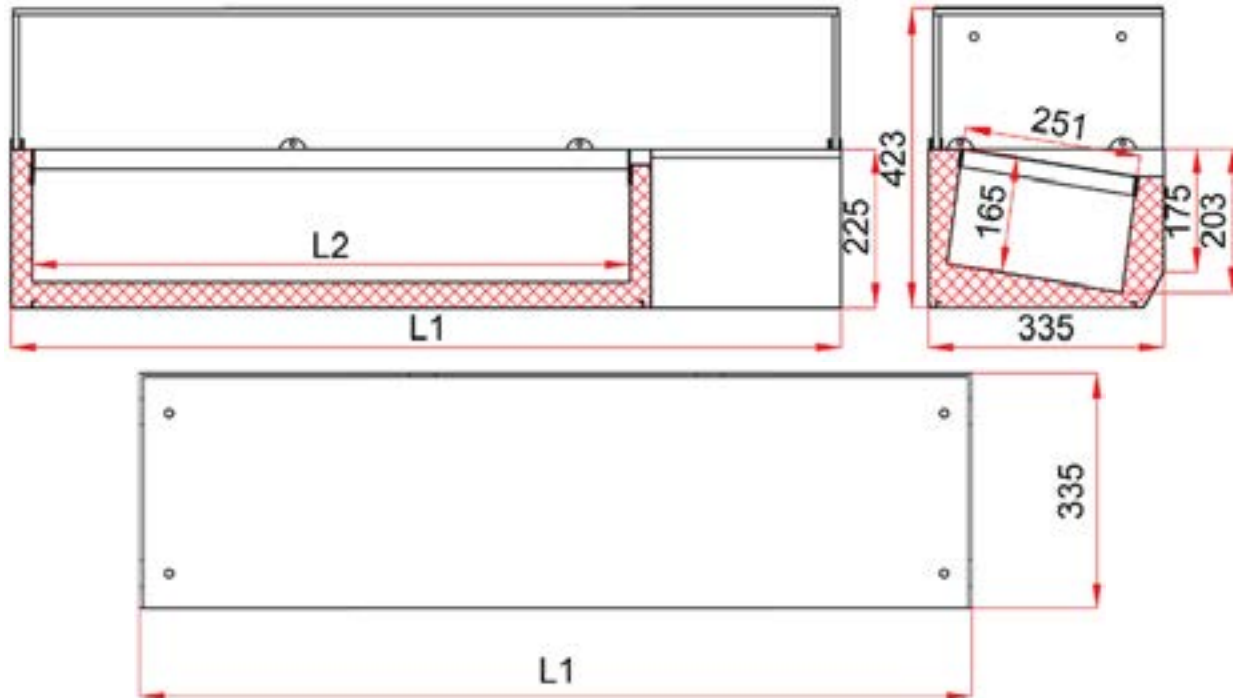

	16000-713	16000-714	16000-740
L1	1180	1480	1980
L2	850	1150	1650